



seko

Pool Series

Launch product

SEKO Pool Series Range Introduction

The **Pool** Series represents a complete refresh of the former PoolBasic range and includes new technology and new models to ensure the most complete customer offer possible.

The following slides provide an overview of the available and planned new products.

SEKO's **Pool** Series consists of:

- **Peristaltic** dosing systems with built in controllers for single, double or triple pumps and integrated multi parameter controllers
- The main functions are: for automatic regulation using measurements for swimming pool or water treatment plant applications.



Pool Series Products



PoolOne

Single unit pH, ORP, Constant or timed dosing.

LED indication; single measure interface; very simple unit designed for non technical operators.



PoolDose LED

Single unit pH and ORP version.

LED indication; single measure interface; very simple unit dedicated for use by semi professionals



PoolDose

Single, Double or Triple version

With mixed combination measurements; digital interface with multi language menu.



PoolMaster

Double or Triple version,

Complete regulation for a pool with Boiler and Circulation pump activation. Digital interface with multi language menu

PoolOne Series Products



PoolOne is the new peristaltic pump that renews the look of SEKO's best selling *PPE* and *Dynamik* pumps. It is designed to be installed mainly in swimming pool applications.

Released models:

- **PNCS:** Analogue or Digital pump model with speed adjustment to dose in constant mode
- **PNCK:** Digital pump model with Timer clock to dose in cyclic mode or batch mode
- **PNPH:** Digital pump model with pH controller to regulate swimming pool environment
- **PNRX:** Digital pump model with ORP controller to regulate chlorine concentration

SEKO POOL SERIES: PoolOne features



PoolOne features and benefits:

- New clean, professional SEKO look with **polished Blue & Black enclosure** and easy to open front cover that allows tool free tube replacement. The cover stops in the open position for easy access.
- **2 rollers and big ball bearing** on the motor shaft interface guarantees improved axial effort and enhancing tube and motor lifespan by 15% - 20%
- **Edge free squeeze rollers** makes tube replacement safer and easier avoiding technician injuries and reducing by 50% the tube replacement time

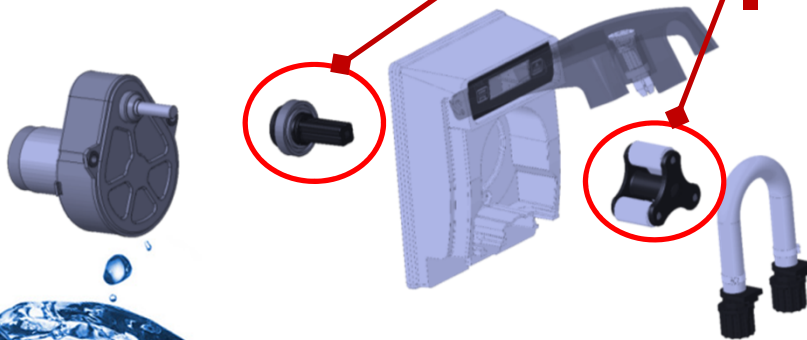

SEKO POOL SERIES: PoolOne features

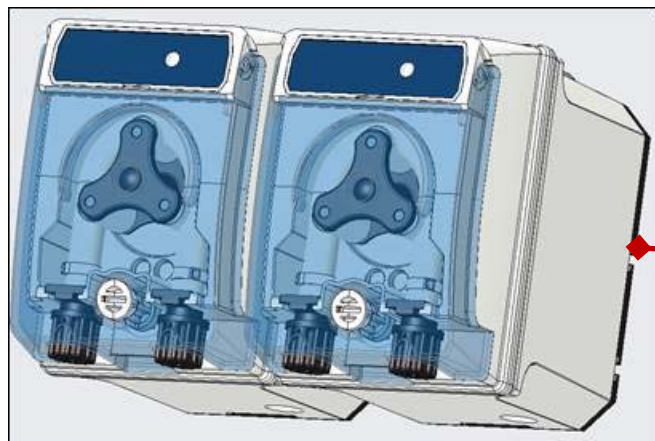

PoolOne features and benefits:

- **New modular bracket** with same footprint as the pump and release lever make pumps easier to install, more stable over time, providing perfect modular alignment and eliminating the risk of the pump falling off the wall.
- The **connection element** is **molded in the bracket** itself and can be easily removed by hand if a two pump connection is needed.

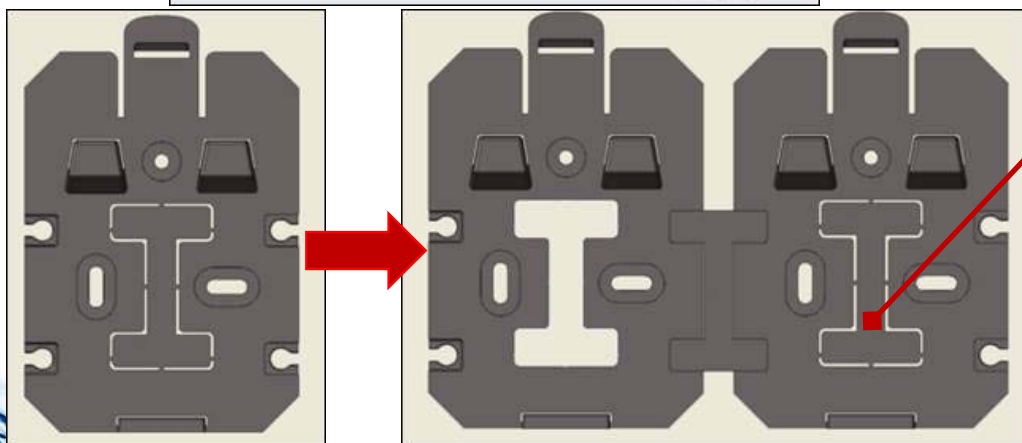

PoolOne range

seko

	CS (Analogue)	CS (Digital)	CK	pH	Rx
Photo					
Code	PNCS1H05A0100 PNCS1H1HA0100 PNCS1H50A0100	PNCS1H0AM0100 PNCS1H0BM0100 PNCS1H0CM0100 PNCS1H0DM0100 PNCS1H0EM0100	PNCK1H40M0100	PNPH1H1HM0100	PNRX1H1HM0100
Measure	Constant dosing	Constant dosing	Timed Dosing	pH Range 6-8 pH	ORP(Redox) Range 600-1000 mV
Flowrate	0,5 L/H-1,5 Bar 1,5 L/H-1,5 Bar 5 L/H-1,5 Bar	25 mL/H-1,5 Bar 151 mL/H-1,5 Bar 1512 mL/H-1,5 Bar 5400 mL/H-1,5 Bar 9750 mL/H-1,5 Bar	4 L/H-1,5 Bar	1,5L/H-1,5 Bar	1,5L/H-1,5 Bar
Poolsize	3 – 50 m³	1 – 110 m³	5 – 130 m³	5 – 110 m³	5 – 110 m³

PoolDose and PoolMaster Series features

- New professional, look with polished **blue & black** enclosure and **easy to open front cover** which allows **tool free tube replacement** as the cover stops in the open position
- Casing features **integrated front keys** and a **robust hinge** means tool free box opening and self supporting hinge keeps the front cover open giving easy and safe access for installation
- **2 rollers and big ball bearing** on motor shaft interface enhances both tube and motor lifespan by 15% - 20%; **edgeless squeeze rollers** makes tube replacement safer and easier avoiding injuries and reducing replacement time by 50%
- **Large fixing bracket with safety release lever** guarantees easy and accurate installation, ensuring a solid wall fixing that reduces accidental damage during operations

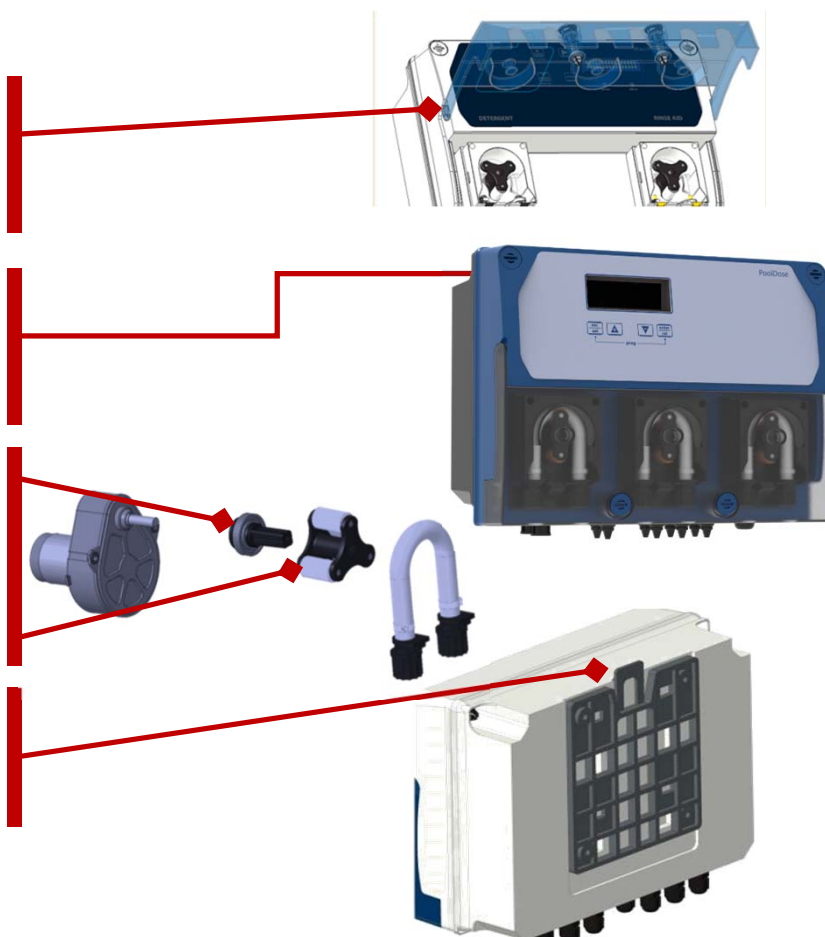

PoolDose and PoolMaster Series features

- PoolDose offer user-friendly analogue or digital combined systems with a peristaltic pump and single measurement with automatic proportional dosing, and multi language menu.
- Proportional dosing TWM (Time With Modulation) mode ensures dosing accuracy **avoiding overdosing**. The charts show how the pump time dosing changes according to the distance of the read value from the set point. The proportional band is fixed, the customer just needs to set the desired value for the Set Point.
- Peristaltic dosing pumps **with 2 PVDF rollers** and Santoprene or SekoExtra tubing
- **Wizard calibration routine** with lifetime indication probe. The controller flashes a percentual value.
- **Circulation pump checks** "Power On" flow trigger, Pool Series ensures right chemical dosing even while swimming pool is open.
- Pool Series also incorporates these additional features in the main board: extra dosing available thanks to pH and chlorine relay, remote alarm relay, input level probe checks product levels.
- **Boiler and circulation pump activation** with PoolMaster only.
- **Insulated Chlorine measure** with amperometric sensor in PPM value, for professional feeling.
- **Installation kit included**: probe, buffer solution, bracket, not return valve, foot filter, probe holder.

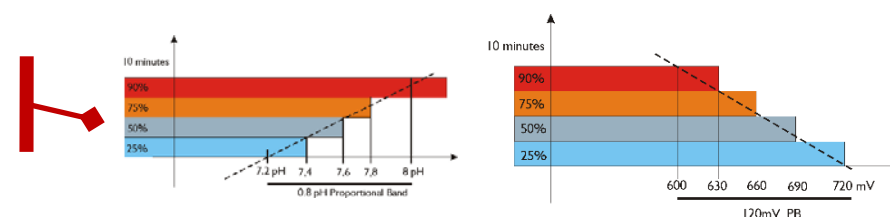

PoolDose and PoolMaster range

	PoolDose LED		PoolDose			PoolMaster				
Photo										
Code	PDPH1H1HA000 PDPH1H50A000	PDMV1H1HA000	PDPH1H1HA001 PDMV1H1HA001	PDMVXXXXA003	PDMVXXXXA002	PDPR1H1HA001 PDPR1H50A000 PDHC1H1HA000 PDHC1H50A000	PDPR1H50A000 PDPR1H50A002 PDPR1H1HA003	PDPR1H1HA004 PDHC1H1HA005	PMPR1H1HA000	PMPR1H1HA001
Measure	pH	ORP (Redox)	pH ORP(Redox)	ORP(Redox)	ORP(Redox)	pH-ORP(Rx) pH-ORP(Rx)-CL	pH-ORP(Rx)	pH-ORP(Rx)-Fluc. pH-ORP(Rx)-CL	pH-ORP(Rx)	pH-ORP(Rx)-Floc.
Flowrate	1,5L/H-1,5 Bar 5 L/H-1,5 Bar	1,5L/H-1,5 Bar	1,5L/H-1,5 Bar	Plug connection for external device	Internal Relay connectios for external device with LED light feedback	1,5L/H-1,5 Bar 5 L/H-1,5 Bar	1,5L/H-1,5Bar Plug connection for external device	1,5L/H-1,5 Bar	1,5L/H-1,5 Bar	1,5L/H-1,5 Bar
Poolsize	5 – 50 m³	5 – 50 m³	5 – 110 m³	5 – 110 m³	5 – 110 m³	5 – 130 m³	5 – 130 m³	5 – 130 m³	5 – 130 m³	5 – 130 m³

PoolOne pumps



PoolOne is a user-friendly analogue or digital combined system with a peristaltic dosing pump and single measurement with automatic dosing that enables chemical adjustment for above ground pools.

Models

- < for CS (constant dosing)
- < for CK (timing dosing)
- < for pH (6,0 – 8.0 pH)
- < for ORP (600 – 1000 mV)

Dosing PUMP

Flow rate 25mL to 9750 mL/h ; Pressure 1.5 bar

Pool Size Indoor 5 – 130 m³ ; Outdoor 5 – 110 m³

Main Board

Led or 7 segment LCD Display

Power supply 220 – 240 Vac 50/60Hz or 100-240 Vac 50/60Hz

IP65 Enclosure

Dimensions 133,5 x 85,0 x 118,3 mm

Material ABS

PoolDose LED



PoolDose LED is a user-friendly analogue combined system with a peristaltic dosing pump and single measurement with automatic proportional dosing that enables chemical adjustment for above ground pools.

Models

- < for pH (6.2 – 8.2)
- < for ORP (480 – 750 mV / 660 – 930 mV)

Proportional Dosing PUMP

Flow rate 1.5 or 5 l/h ; Pressure 1.5 bar

Pool Size Indoor 5 – 130 m³ ; Outdoor 5 – 110 m³

Main Board

Display LED

Power supply 220 – 240 Vac 50/60Hz

IP65 Enclosure

Dimensions 235 x 165,4 x 137,2 mm

Material ABS



PoolDose SINGLE



PoolDose Single delivers a user-friendly solution combining a peristaltic dosing pump and single measurement with automatic proportional dosing that adjusts the chemical parameters for above ground pools.

Models

< for pH (0 – 14)

< for ORP (0 – 1000 mV)

■ for ORP with schuko (0 – 1000 mV)

■ for ORP with Internal Relay (0 – 1000 mV)

■ Internal Relay connections for external device with LED light feedback

Main Board

Alphanumeric display 16 letters x 2 lines

Power supply 220 Vac 50/60Hz

IP65 Enclosure

Dimensions 235 x 165,4 x 137,2 mm

Material ABS

Proportional Dosing Pump (TWM: Time with modulation)

Flow rate 1.5 or 5 l/h ; Pressure 1.5 bar

Pool Size Indoor 1 – 130 m³ ; Outdoor 1 – 110 m³

PoolDose DOUBLE



Offering the fullest range of possible measurements, the **PoolDose Double** range still offers a user-friendly solution. It combines two peristaltic dosing pumps and a multi measurement capability with automatic proportional dosing designed for above ground, indoor and outdoor pools. PoolDose is also available with a 3 pump configuration.

PoolDose double pump standard models:

- < for pH (0 – 14) and ORP (0 – 1000 mV)
- < for pH (0 – 14) and ORP with schuko (0 – 1000 mV)
- < for pH Plus (0 – 14) and pH minus (0 – 14)
- < for pH (0 – 14) and Flocculant dosage
- < for pH (0 – 14) and Hydrogen peroxide(*)
- < for pH (0 – 14) and ORP (0 – 1000 mV) and Conductivity (0 – 20000 µS)
- < for pH (0 – 14) and ORP (0 – 1000 mV) and Free chlorine (0 – 5 ppm)(**)

PoolDose Double Pump Modbus Protocol Communication for SekoWeb

- < for pH (0 – 14) and ORP (0 – 1000 mV) and Free chlorine (0 – 5 ppm) (**)

PoolDose Double Pump B-WEEKLY Timer Version

- for pH (0 – 14) and Hydrogen peroxide(*)

PoolDose Double Pump SPA Version

- < for pH (0 – 14) and ORP (0 – 1000 mV)
- < for pH (0 – 14) and ORP (0 – 1000 mV) and Free chlorine (0 – 5 ppm) (**)

PoolDose Triple Pump Version

- < for pH (0 – 14) and ORP (0 – 1000 mV) and Flocculant dosage
- < for pH Plus (0 – 14) and ORP (0 – 1000 mV) and pH minus (0 – 14)
- < for pH (0 – 14) and ORP (0 – 1000 mV) and Free chlorine (0 – 5 ppm)(**) and Flocculant dosage

Proportional Dosing Pumps

Flow rate 0.4 or 1.5 or 5 l/h ; Pressure 1.5 bar

Pool Size Indoor 1 – 130 m³; Outdoor 1 – 110 m³

Main Board

Alphanumeric display 16 letters x 2 lines

Power supply 220 Vac 50/60Hz

IP65 Enclosure

Dimensions 240 x 304 x 137,2 mm

material ABS

(*) By time and temperature compensation

(**) With Free Chlorine Amperometric probe

PoolMaster DOUBLE / TRIPLE



PoolMaster is an advanced combined system available with two or three peristaltic pumps with either automatic proportional or timed dosing that adjusts chemical parameters for both outdoor pools and spa centers. Furthermore, the **PoolMaster** comes with additional functions built in. The first is a weekly timer to regulate the circulation pump and the second is a temperature sensor that activates the boiler using a relay switch.

PoolMaster Double Pump Version
for pH (0 – 14) and ORP (0 – 1000 mV)

PoolMaster Triple Pump Version
< for pH (0 – 14), ORP (0 – 1000 mV) and
Flocculant dosage

Proportional Dosing Pump
Flow rate 1.5 or 5 l/h ; Pressure 1.5 bar

Pool Size Indoor 1 – 130 m³; Outdoor 1 – 110 m³

**Circulation Pump and Boiler Activation By
Powered Relay** max 1.5 kW load

Main Board
Alphanumeric display 16 letters x 2 lines
Power supply 220 Vac 50/60Hz

IP65 Enclosure
Dimensions 240 x 304 x 137,2 mm
material ABS

Your Choice,
Our Commitment

SWAT Analysis Pool Series

Strengths

- Wizard Calibration process uses high quality pH and ORP probes
- Amperometric sensor measures chlorine ppm value
- Circulation and boiler controller thanks to PoolMaster controller
- Circulation pump checks "Power On" flow trigger
- Remote alarm relay
- Input level probe checks product levels
- Installation kit included
- Proportional peristaltic dosing routine and extra dosing available thanks to pH and chlorine relay
- New product design
- IoT connection platform by serial port
- Complete product collection model

Weaknesses

- Graphic display
- IoT connection using WiFi connection

Opportunities

- Complete, compact solutions for residential pools and SPA
- Complete range for Pool Shop

Threats

- Small local competitors
- Aggressive competitors prices



SEKO Pool Series Range



PoolOne



PoolDose LED



PoolDose



PoolMaster